



**Model Number**

**CBB10-30GK60-E2**

**Features**

- 10 mm flush
- Operating distance adjustable via potentiometer
- High EMC resistance

**Accessories**

**BF 30**  
Mounting flange, 30 mm

**Technical Data**

<b>General specifications</b>	
Switching function	Normally open (NO)
Output type	PNP
Rated operating distance	$s_n$ 10 mm
Installation	flush
Output polarity	DC
Assured operating distance	$s_a$ 0 ... 8.1 mm
Output type	3-wire
<b>Nominal ratings</b>	
Installation conditions	
A	0 mm
B	0 mm
C	20 mm
F	40 mm
Operating voltage	$U_B$ 10 ... 30 V DC
Switching frequency	f 0 ... 10 Hz
Reverse polarity protection	reverse polarity protected
Short-circuit protection	pulsing
Voltage drop	$U_d$ ≤ 2.8 V
Operating current	$I_L$ 0 ... 200 mA
Off-state current	$I_r$ 0 ... 0.5 mA typ. 0.1 µA at 25 °C
Off-state current $T_U = 40$ °C, switching element off	≤ 100 µA
No-load supply current	$I_0$ ≤ 20 mA
Time delay before availability	$t_v$ ≤ 50 ms
Switching state indicator	LED, yellow
<b>Functional safety related parameters</b>	
MTTF <sub>d</sub>	760 a
Mission Time ( $T_M$ )	20 a
Diagnostic Coverage (DC)	0 %
<b>Indicators/operating means</b>	
Potentiometer	sensitivity adjustment
<b>Ambient conditions</b>	
Ambient temperature	-25 ... 70 °C (-13 ... 158 °F)
Storage temperature	-40 ... 85 °C (-40 ... 185 °F)
<b>Mechanical specifications</b>	
Connection type	cable PVC , 2 m
Housing material	PBT
Sensing face	PBT
Degree of protection	IP67
<b>Compliance with standards and directives</b>	
Standard conformity	
Standards	EN 60947-5-2:2007 EN 60947-5-2/A1:2012 IEC 60947-5-2:2007 IEC 60947-5-2 AMD 1:2012
<b>Approvals and certificates</b>	
UL approval	cULus Listed, General Purpose

**Dimensions**

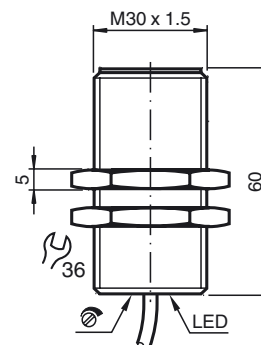

**Electrical Connection**

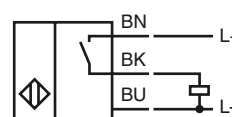

Release date: 2018-10-09 11:03 Date of issue: 2018-10-09 237549\_eng.xml

Installation Conditions

