



### Model Number

**V1-PG13,5-Y124355**

Receptacle, M12/PG13.5, 2-pin; plastic

### Features

- Plastic version
- Front/screw mounting
- M12 plug can be mounted in any position
- Only two pins assigned

### Dimensions

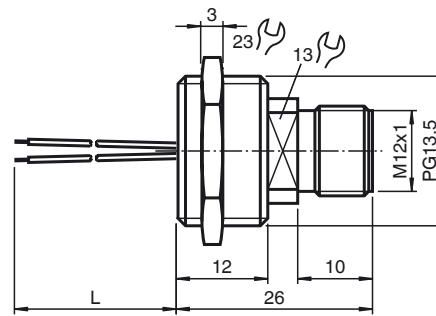

### Technical data

#### General specifications

Number of pins	4
----------------	---

#### Mechanical specifications

Degree of protection	IP67 when sealing with O-Ring
Connection	Single strand leads with connector sleeves
Material	
Connector	plastic
Core insulation	PVC
Cable	
Number of cores	2
Core cross-section	0.25 mm <sup>2</sup>
Length	L
Installation	Front mounting PG13.5

#### Compliance with standards and directives

Standard conformity	
Degree of protection	EN 60529

### Electrical connection

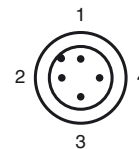

### Electrical connection

1	BN
2	
3	BU
4	

### Note

O-ring (13,3 x 1,5) and lock nut are included and assembled.